

- KEYNOTES**
1. DISPOSE WALLS AND METAL STUD FRAMING
  2. CONCRETE LOCKER
  3. BRICK WORK
  4. ALUMINUM WINDOW
  5. CONCRETE COLUMN
  6. GLASS CURTAIN WALL SYSTEM
  7. STEEL COLUMN
  8. PRECAST SLAB
  9. FIRE EXTINGUISHER
  10. FIRE EXTINGUISHER CABINET
  11. ELEVATOR
  12. ALUMINUM COLUMN
  13. TYPICAL PARTITION
  14. GYM WALK (WORK)
  15. COVERED BALCONY
  16. SHOWER DEVICE
  17. METAL LOCKER
  18. METAL STUD AND GATE
  19. FIRE CURTAIN
  20. SERVICE VENT
  21. ROOF ACCESS TO ROOF
  22. REMOVE (G) PORTION OF CONCRETE WALL TO ALLOW THE INSTALLATION OF
  23. DOOR & FRAME
  24. CONCRETE BEAMS TO REMAIN
  25. FINISHED CONCRETE
  26. NOT USED
  27. CONCRETE TO BE AT LOCKERS
  28. EXPANSION JOINT WITH GASKET ASSEMBLY
  29. ANCHORING IRON PRECAST CONC. CAP
  30. CHAIRING / SEE WALK
  31. LINE OF CONC. BEAM ABOVE
  32. LINE OF CONC. Y ABOVE
  33. CHAIN LINK TO KE
  34. NOT USED
  35. BASKETBALL B COLUMNS
  36. 8" DIA. BALLA D
  37. FLAGPOLE
  38. VERTICAL IRON TO BE IN EXPANDED COLUMN
  39. 4" WIDE x 4" HIGH CONC. SEE FOOD SERVICE EQUIPMENT
  40. REFER TO 10 SERVICE BUNDLES FOR EQUIPMENT TIE AREA
  41. FLOOR TRUCK II
  42. ROOF BEAMS TO SYSTEM
  43. TOP OF CMU WALL AT 21'-0" SEE FOOD SERVICE DRAWINGS
  44. STRUCTURE FROM TRUSS CEILING

- GENERAL NOTES**
1. SEE SHEETS M-001 - M-208 FOR INTERIOR ELEVATIONS
  2. ASSUMED FINISH FLOOR ELEVATION 0'-0" FOR BOARD FLOOR AND 14'-2" FOR SECOND FLOOR (IF APPLIED) COORDINATE ACTUAL FINISH FLOOR WITH CIVIL DRAWINGS
  3. UNLESS NOTED OTHERWISE, INTERIOR PARTITION TYPES SHOWN ARE REFER TO A-101 FOR INTERIOR PARTITION SCHEDULE



**MOUNT DORA HIGH SCHOOL**  
 Doral  
 Lake County Schools  
 201 West Burleigh Boulevard  
 Doral, Florida 33176

Architect  
  
**C.T. HSU & ASSOCIATES, P.A.**  
 620 West Avenue, Orlando, FL 32805  
 Tel: 407-622-6666 Fax: 407-622-4793

**NOTICE**  
 The title in this document is for general information only. It is not intended to be a contract. All drawings and specifications are subject to change without notice. The contractor shall be responsible for obtaining all necessary permits and for complying with all applicable laws and regulations. C.T. HSU & ASSOCIATES

Revised/Signatures

No.	By	Date	Revision

07/30/03 100% CD  
 No. By Date Issued For

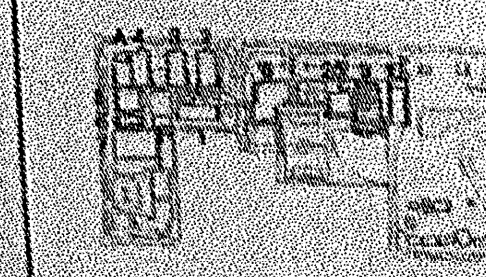

Key Plan  
**BUILDING - 9 FLOOR PLAN**  
 Sheet Title  
 Job No. 0205.00  
 Date 07/30/03  
 Scale 1/8" = 1'-0"  
 File A1109

**A1.109**  
 Sheet No.