

FOUNDATION & SLAB PLAN - BLDG 04
1/8"=1'-0"

- NOTES:
- COORDINATE ALL WALL DIMENSIONS WITH ARCHITECTURAL DRAWINGS (INCLUDING NOM. WALL THICKNESS).
 - FIN GROUND FLR EL. = 100'-0" (TYPICAL, UNLESS NOTED OTHERWISE) FIN GROUND FLR REF. EL. = * N.G.V.D. (* SEE CIVIL DRAWINGS)
 - ELEVATIONS T/FOOTING. SEE FOOTING SCHEDULE.
 - SEE DWG S-3 FOR FOOTING SCHEDULE.
 - SEE DWG S-4 FOR MASONRY WALL (MW) SCHEDULE. WALLS NOT DESIGNATED ARE MW32, EXCEPT 4" CMU AT CHASES.
 - SEE DWG S-10 FOR GENERAL NOTES.

BY: CBEK
LAA/AHR

DATE: 11-24-03
REVISION: EL. D.O.E. COMMENTS

REVISIONS:

1. B. ARCHITECTS ENGINEERS, INC.
MELBOURNE / ORLANDO / WEST PALM BEACH
3876 SUNRISE BOULEVARD
MELBOURNE, FLORIDA 32840
State of Florida License No. JC 000148
School of Architecture License No. JC 000148
Professional Seal of Andrew H. Miller, P.E.
This plan was prepared by Andrew H. Miller, P.E.
and is not to be used for any other project.

MASONRY WALL SCHEDULE (SEE NOTE 1 BELOW)

MARK	THICKNESS	VERTICAL REINFORCING	HORIZONTAL REINFORCING		TOP OF WALL	REMARKS
			BEAM	TOP OF BEAM		
MW1	8"	*	BB1	109'-4"	112'-0"	* SEE DWG. S-2, BLDG. 02
MW2	8"	#5 @ 48" O.C.	BB1	109'-4"	112'-0"	
MW3	8"	#5 @ 48" O.C.	BB2	113'-4"	113'-4"	
MW4	8"	#5 @ 48" O.C.	BB1 **	109'-4"	112'-0"	* BELOW WINDOW ONLY **CONT ABOVE WINDOW LION
MW5	8"	#5 @ 48" O.C.	BB1	110'-0"	110'-0"	
MW6	8"	#5 @ 48" O.C.	BB1	110'-0"	110'-0"	
MW7	8"	#5 @ 40" O.C.	BB1	110'-0"	110'-0"	
MW8	8"	#5 @ 48" O.C.	BB2, BB2*	109'-4"	VARIES	* SEE SECTION "B", "C", "D" ON S-9
MW9	8"	#5 @ 48" O.C.	TB3	108'-0" TO 109'-8"	VARIES	
MW10	8"	#5 @ 48" O.C.	TB3	108'-0"	108'-0"	
MW11	8"	#5 @ 48" O.C.	TB3	109'-8"	109'-8"	
MW12	8"	#6 @ 24" O.C.	TB1	112'-8" TO 115'-4"	VARIES	
MW13	8"	#5 @ 48" O.C.	TB1	112'-8" TO 115'-4"	VARIES	
MW14	8"	#6 @ 24" O.C.	TB1	112'-8"	112'-8"	
MW15	8"	#5 @ 48" O.C.	TB1	115'-4"	115'-4"	
MW16	8"	#5 @ 48" O.C.	BB1, BB2	110'-8", 114'-0"	114'-0"	
MW17	8"	#5 @ 72" O.C.	BB2	111'-4"	111'-4"	
MW18	8"	#5 @ 40" O.C.	BB1, TB1	110'-0", 117'-5 1/2" TO 121'-8 1/4"	VARIES	
MW19	8"	#5 @ 40" O.C.	BB1, TB2	110'-0", 117'-5 1/2"	117'-5 1/2"	
MW20	8"	#5 @ 48" O.C.	BB1, BB2*	110'-0"	VARIES	* SEE SECTION "B", "C", "D" ON S-9
MW21	8"	#5 @ 48" O.C.	BB1, BB2*	109'-4"	VARIES	* SEE SECTION "B", "C", "D" ON S-9
MW22	8"	#5 @ 48" O.C.	BB1, BB2*	111'-4"	VARIES	* SEE SECTION "B", "C", "D" ON S-9
MW23	8"	#5 @ 48" O.C.	BB1, BB2*	110'-0"	VARIES	* SEE SECTION "B", "C" ON S-9
MW24	8"	#5 @ 16" O.C.	BB1, BB2*	110'-0"	VARIES	* SEE SECTION "B" ON S-9
MW25	8"	#5 @ 48" O.C.	BB1, BB2*	109'-4"	VARIES	* SEE SECTION "B", "C", "D" ON S-9
MW26	8"	#5 @ 48" O.C.	BB1, BB2	108'-8", 111'-4"	111'-4"	
MW27	8"	#5 @ 48" O.C.	BB1	110'-8"	110'-8"	
MW28	8"	#5 @ 72" O.C.	BB2	112'-8"	112'-8"	
MW32	8"	#5 @ 72" O.C.	BB2	109'-4"	109'-4"	
MW33	8"	#5 @ 48" O.C.	TB2, BB2*	109'-4"	VARIES	* SEE SECTION "B", "C", "D" ON S-9

NOTE 1:
SEE "GENERAL NOTES-MASONRY" DWG. S-10 FOR ADDITIONAL MASONRY AND REINFORCING REQUIREMENTS, TYPICAL ALL MW'S.

BB1 8" x 16" DOUBLE MASONRY BOND BEAM W/ (2) #4 TOP & (2) #4 BOTT, CONT
BB2 8" x 8" MASONRY BOND BEAM W/ (2) #4 CONT

TB1 8" x 12" MIN. TIE BEAM W/ (2) #5 T & (2) #5B CONT AND #3 TIES @ 16" O.C.
TB2 8" x 16" TIE BEAM W/ (2) #5 T & (2) #5B CONT AND #3 TIES @ 16" O.C.
TB3 1 1/2" x 12" MIN TIE BEAM W/ (2) #5 T & (2) #5 B, CONT & #3 TIES @ 16" O.C.

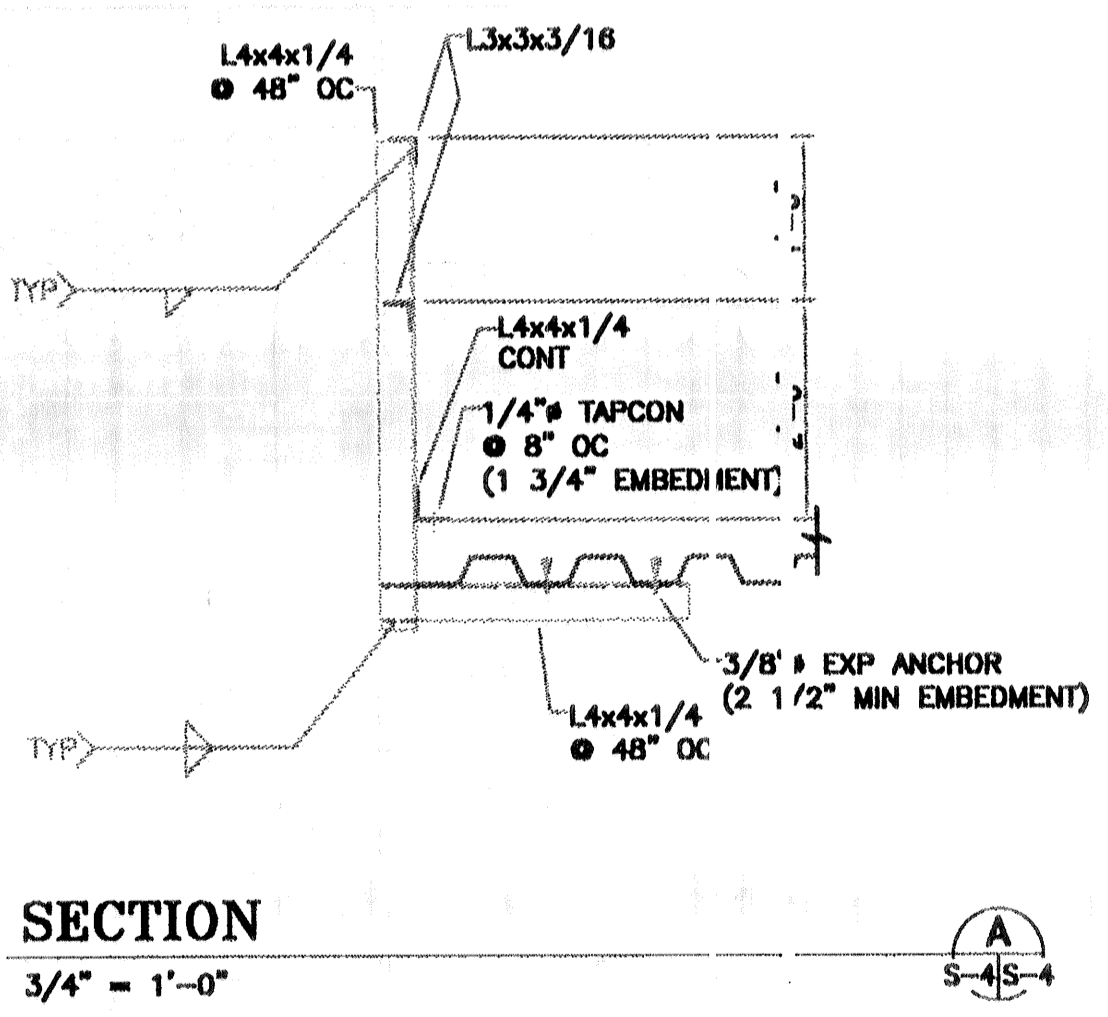

SECTION
3/4" = 1'-0"

RECORD DRAWING

DESIGNED BY: A. MILLER
DRAWN BY: L. ARCHER
CHECKED BY: ANDREW H. MILLER, P.E.
PROJECT NO.: 5284.01/S04
DATE: 06-16-03
DRAWING NO.: S-4

KEY PLAN

0' 6" 1' 2' 3' 4'
3/4" = 1'-0"

0' 4' 8' 16' 24'
1/8" = 1'-0"